

Made in Italy
意大利製造

EFFEGIBREVETTI

SLIDING OPENING SYSTEM FOR COPLANAR DOORS

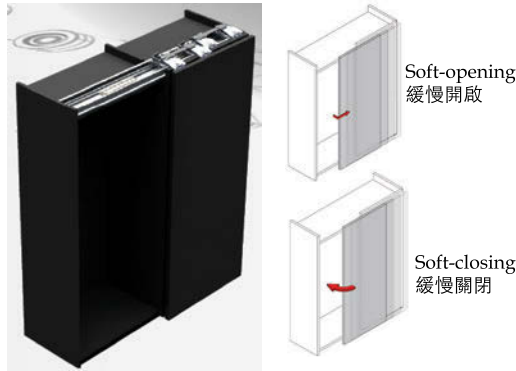

'PLANO' coplanar sliding door system for overlay application with soft-opening and soft-closing devices

'PLANO'大型平面橫移門系統用五金配件套裝，帶緩衝開閉裝置，外置門適用

Door thickness 門厚	: 18-30 mm
Door weight 門重	: Max. 60 kg per door for 2-door application 雙門時，每扇門不超過60 kg
	: Max. 35 kg per door for 3-door application 三門時，每扇門不超過35 kg
Cabinet width 櫃寬	: 1800-3000 mm
Handle protrusion 拉手突出	: Max. 20 mm 不超過20 mm

Door closing force adjustment 門關閉力度調節

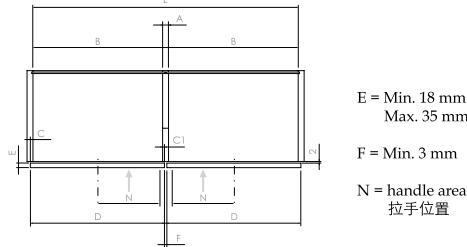
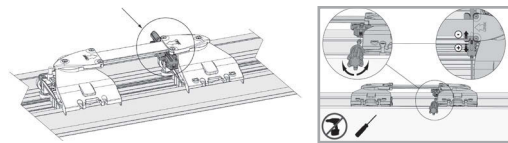

'PLANO' 2 doors soft version - Pre-mounted set

'PLANO'雙扇平面移門系統用五金配件套裝，帶緩衝開閉

Model No. 型號	Door Width 門寬
HKS-2719A	620-900 mm
HKS-2719B	1001-1200 mm
HKS-2719C	1201-1500 mm



Cabinet construction dimensions for 'PLANO' 2 doors pre-mounted set (with side panel thickness 18 mm)*

'PLANO'雙扇平面移門系統預設的櫃體結構尺寸(側板18 mm 厚)*

Model No. 型號	B	D	L	C
HKS-2719A	864	896	1764	16
HKS-2719B	1164	1196	2364	16
HKS-2719C	1464	1496	2964	16

* Should the dimensions of your cabinet differ from the above, please consult with our sales team for the correct aluminium profile (tracks, linking bars & cover profiles) length and drilling pattern on doors, top panel and bottom panel

* 如果客人的櫃體尺寸、開口尺寸、側板厚度與以上預設的尺寸有所不同，請諮詢我銷售人員有關鋁質配件所需修改的尺寸，門板、頂板及底板的正確開孔位置

Additional component kits for 'PLANO' 3 doors version*

另外加配'PLANO'三扇平面移門系統用五金套件*

Model No. 型號	Description 內容
HKS-2720	Kit soft-opening for middle door 中門用緩衝開閉裝置套裝
HKS-2721/L	'PLANO' sliding unit - middle door left opening 'PLANO'左開中間平面移門系統用五金套件
HKS-2721/R	'PLANO' sliding unit - middle door right opening 'PLANO'右開中間平面移門系統用五金套件

* Note 注意：

- The component kits of 'PLANO' 3 doors version are used with HKS-2719C 'PLANO' 三扇平面移門系統用五金套件需配合HKS-2719C一併使用
- For 'PLANO' 3 doors version, the minimum door width is 900 mm (per door) 'PLANO' 三扇平面移門系統下的門寬最小為900 mm (每扇門)

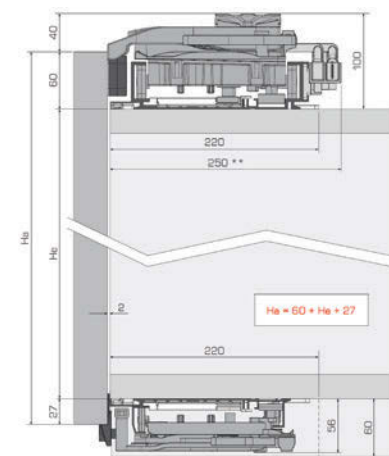

3D door adjustment:
horizontal, vertical & depth
3維門板調節:
左右、上下及前後

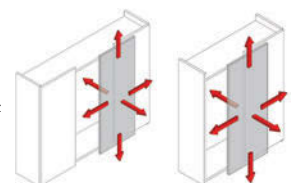



HONGKONG HARDWARE SUPPLIER LTD

香港裝飾材料有限公司

Gewichtsbereich Türe Door weight range Plage de poids de port	Anwendung Application Application	Einsatzbereich Area of application Domaine d'utilisation	Designvariante Design variant Variante de design	Lauftechnik Running system Système de roulement	Schrankhöhe (max.) Cabinet height (max.) Hauteur d'armoire (max.)	Schrankbreite Cabinet width Largeur d'armoire
20kg	Sideboard, Highboard Oberschrank	Wohnen, Büro Living room, office Salon, bureau		UL	1000	1200 - 2400
	Sideboard, Highboard, Wall cabinet			OL	1000	1200 - 2400
	Sideboard, Highboard, Meuble haut			OL	1000	1200 - 2400
	Oberschrank	Küche Kitchen Cuisine		OL	1000	1200 - 2400
	Wall cabinet Meuble haut					
40kg	Hochschrank Tall cabinet Armoire haut	Wohnen, Schlafen, Eingang, Büro Living room, be- droom, entrance, office Salon, chambre à choucher, entrée, bureau		OL	2400	1200 - 2400

OL = Obenlaufend/Top running/Roulement en haut

UL = Untenlaufend/Bottom running/Roulement en bas

Hawa Frontino 20 H OS FS





Hawa Frontino 20 H FS

Hawa Frontino 20 H FS



HONGKONG HARDWARE SUPPLIER LTD

香港裝飾材料有限公司





Hawa Frontino 40 H FS

Hawa Frontino 40 H FS



HONGKONG HARDWARE SUPPLIER LTD

香港裝飾材料有限公司

